

PRODUCT DRAWING

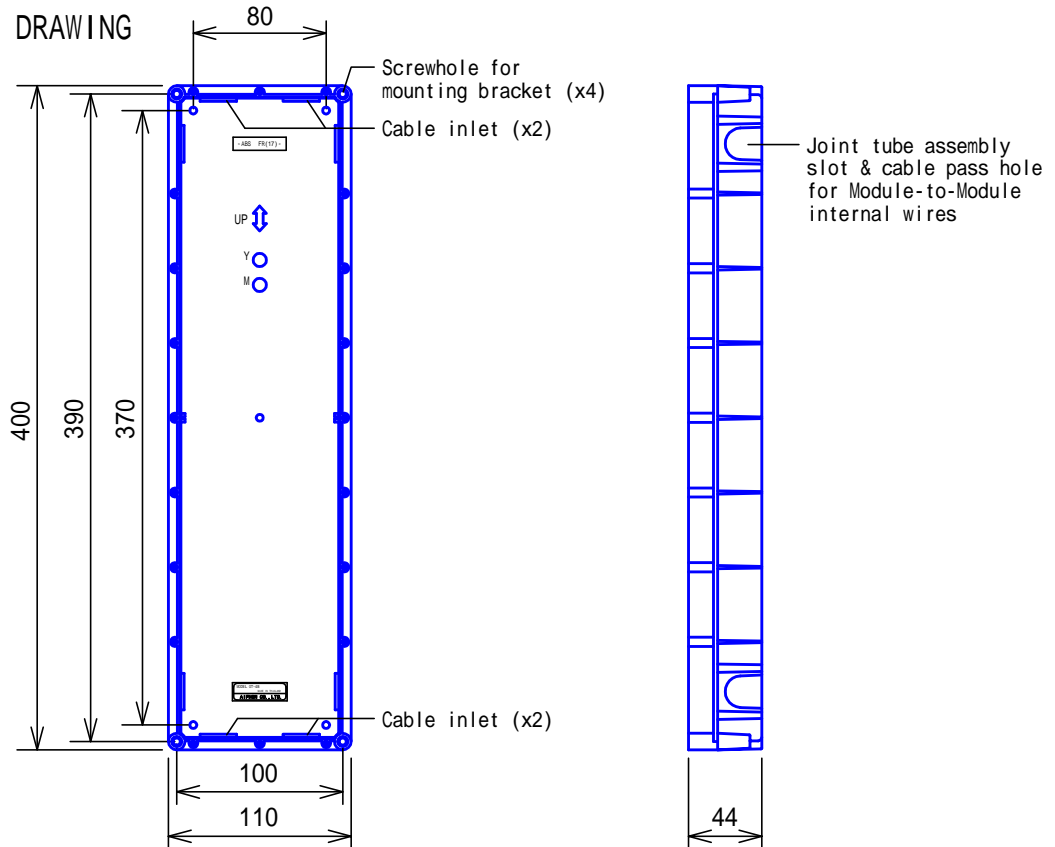

MOUNTING

Example; Two x GT-4B assembled

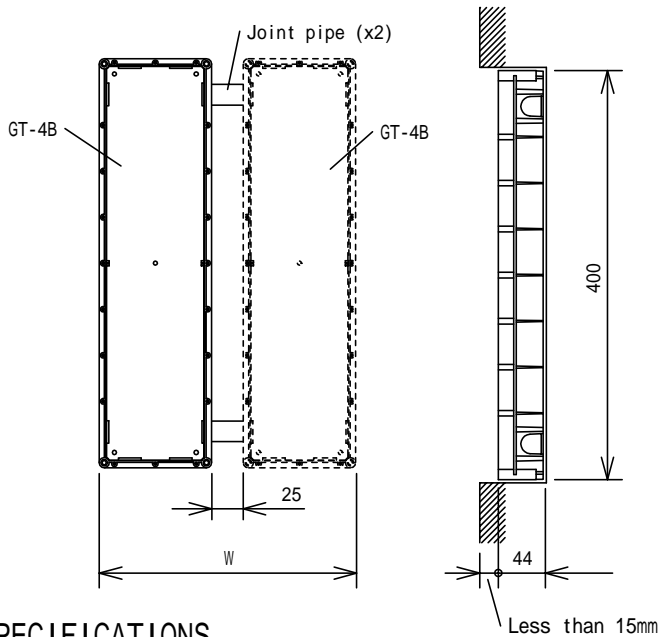

4-Module back box	W (mm)
1 row	110
2 rows	245
3 rows	380
4 rows	515

Note:

- \* Opening in the wall should not be more than 59mm deep.
- \* For best results, mount the back box strictly horizontally.

SPECIFICATIONS

Mounting	Flush wall-mount.
Housing	Fire-retardant ABS plastic
Weight	230g(approx.)
Remarks	Used for: GT-4F

DESCRIPTION <b>4-MODULE BACK BOX</b>	FIG. NAME <b>PRODUCT/SPECIFICATIONS</b>	UNIT mm	DATE 11 March, 2011
MODEL NO. <b>GT-4B</b>	FIG.NO. G57437-1-1	PAGE 1/1	REVISION 1

**AIPHONE**